

# Curve

Elbows, Coudes

Saldate a 90° R=1.5Ø

DN	Ext diam. mm	Th./(mm) Kg/pz.			
		1.5	2	2.5	3
3/8"	17.2	0.05	0.05	-	-
1/2"	21.3	0.06	0.06	-	-
3/4"	26.9	0.07	0.07	-	-
1"	33.4	0.08	0.11	-	-
1 1/4"	42.4	0.09	0.13	-	-
50	53.0	0.24	-	-	-
	54.0	-	0.32	-	-
65	68.0	0.39	-	-	-
	69.0	-	0.54	-	-
80	83.0	0.59	-	-	-
	84.0	-	0.80	-	-
100	103.0	0.91	-	-	-
	104.0	-	1.24	-	-
	105.0	-	-	1.57	-
125	128.0	1.42	-	-	-
	129.0	-	1.92	-	-
	130.0	-	-	2.42	-
150	153.0	2.04	-	-	-
	154.0	-	2.74	-	-
	155.0	-	-	3.46	-
	178.0	2.76	-	-	-
175	179.0	-	3.72	-	-
	180.0	-	-	4.69	-
	203.0	3.60	-	-	-
200	204.0	-	4.84	-	-
	205.0	-	-	6.09	-
	254.0	-	7.53	-	-
250	255.0	-	-	9.47	-
	256.0	-	-	-	11.43
300	304.0	-	10.81	-	-
	305.0	-	-	13.58	-
	306.0	-	-	-	16.37

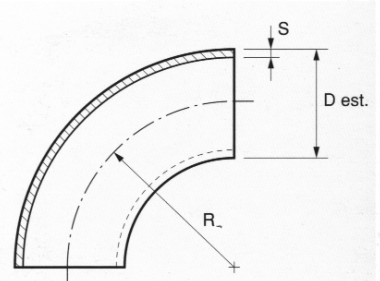

DN	Ext diam. mm	Th./(mm) Kg/pz.				
		2	2.5	3	4	5
350	354	14.68	-	-	-	-
	355	-	18.43	-	-	-
	356	-	-	22.21	-	-
400	405	-	24.02	-	-	-
	406	-	-	28.93	-	-
	408	-	-	-	38.86	-
450	455	-	24.02	-	-	-
	456	-	-	36.54	-	-
	458	-	-	-	49.04	-
500	506	-	-	45.04	-	-
	508	-	-	-	60.41	-
600	606	-	-	64.69	-	-
	608	-	-	-	86.68	-
700	706	-	-	87.90	-	-
	708	-	-	-	117.69	-
800	808	-	-	-	232.00	-
	810	-	-	-	-	290.00
900	908	-	-	-	293.00	-
	910	-	-	-	-	367.00

## Dimensioni metriche

A richiesta si possono fornire curve con raggi di curvatura R= 1Ø - 2Ø - 2.5Ø - 3Ø e ampio raggio.

Elbows with R= 1Ø - 2Ø - 2.5Ø - 3Ø and larger radii manufactured upon request.

Sur demand, coudes avec rayon R= 1Ø - 2Ø - 2.5Ø - 3Ø et avec grand rayon.

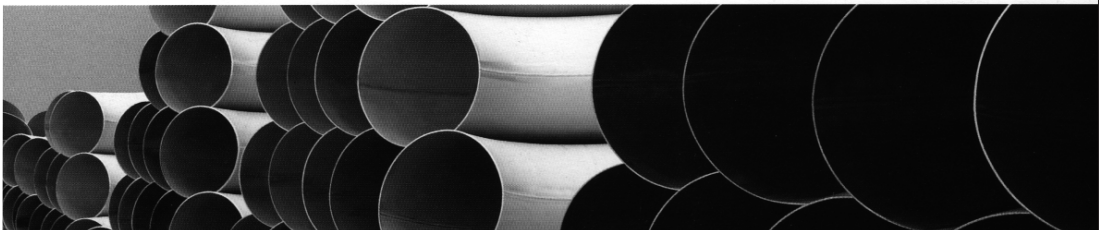

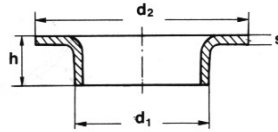

Cartella a saldare

DN-ND	Ø GAS	d <sub>1</sub>	d <sub>2</sub>	Standard	DIN 2642	S				
				h	h	1,5	2	2,5	3	4
8	1/4"	13,7	40	6		•	•			
10	3/8"	17,2	40	6	9	•	•			
15	1/2"	21,3	45	6	9	•	•	•		
20	3/4"	26,9	58	6	12	•	•	•	•	
25	1"	33,7	68	8	15	•	•	•	•	
32	1" 1/4	42,4	78	10	15	•	•	•	•	
40	1" 1/2	48,3	88	10	17	•	•	•	•	
50	2"	60,3	102	12	23	•	•	•	•	
65	2" 1/2	76,1	122	12	23	•	•	•	•	•
80	3"	88,9	139	12	23	•	•	•	•	•
	3" 1/2	101,6	158	12		•	•	•	•	•
100	4"	114,3	158	14	28	•	•	•	•	•
125	5"	139,7	188	14	30	•	•	•	•	•
150	6"	168,3	212	16	30	•	•	•	•	•
200	8"	219,1	270	18	30	•	•	•	•	•
250	10"	273	320	20	30	•	•	•	•	•
300	12"	323,9	370	20	35	•	•	•	•	•
350	14"	355,9	430	25	35	•	•	•	•	•
400	16"	406,4	482	25	40	•	•	•	•	•
450	18"	457,2	532	25	40	•	•	•	•	•
500	20"	508	585	25	40	•	•	•	•	•
600	24"	609,6	685	30	40	•	•	•	•	•

Rigati, saldati e rullati - Collars with grooved face, rolled and welded - Collets cannelés, roulés et soudés

Int. diam. mm	H	D	Th/(mm)	Kg/pz.
50	24	98	2.5	0.18
65	26	118	2.5	0.25
80	28	135	2.5	0.31
100	30	160	3.0	0.50
125	35	185	3.0	0.65
150	34	210	3.0	0.76
175	37	240	3.0	0.96
200	36	265	3.0	1.07
250	38	315	3.0	1.35
300	38	365	4.0	2.12

Int. diam. mm	H	D	Th/(mm)	Kg/pz.
350	39	420	4.0	2.60
400	45	480	4.0	3.43
450	47	530	4.0	3.93
500	50	578	5.0	5.49
600	57	690	5.0	7.60
700	50	805	6.0	10.64
800	60	880	6.0	11.62
900	60	980	6.0	13.04
1000	60	1080	6.0	14.46



Dimensioni ASME B16.9 - dimensioni metriche

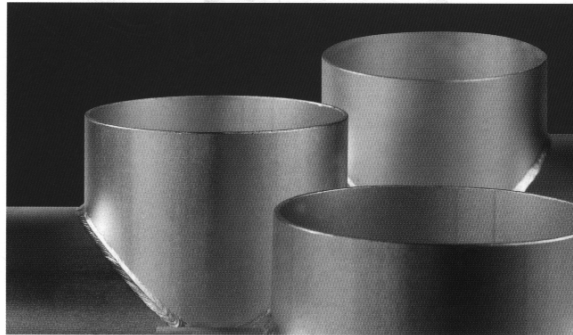
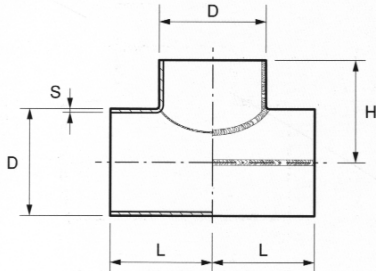

Esecuzione: saldati e ricavati da tubo saldato - Construction: welded from welded pipe - Exécution: soudés à partir de tubes soudés

DN	Ext diam. mm	Th.(mm) Kg/pz.			DN	Ext diam. mm	Th.(mm) Kg/pz.				
		1.5	2	2.5			2	2.5	3	4	5
3/8"	17.2	0.02	0.03	-	254	7.23	-	-	-	-	-
1/2"	21.3	0.04	0.05	-	255	-	9.09	-	-	-	-
3/4"	26.9	0.06	0.08	-	256	-	-	10.98	-	-	-
1"	33.4	0.09	0.12	-	304	10.38	-	-	-	-	-
1 1/4"	42.4	0.15	0.19	-	305	-	13.03	-	-	-	-
50	53.0	0.23	-	-	306	-	-	15.72	-	-	-
	54.0	-	0.32	-	354	14.09	-	-	-	-	-
65	68.0	0.38	-	-	355	-	17.68	-	-	-	-
	69.0	-	0.52	-	356	-	-	21.30	-	-	-
80	83.0	0.57	-	-	405	-	23.03	-	-	-	-
	84.0	-	0.78	-	400	406	-	-	27.74	-	-
100	103.0	0.89	-	-	408	-	-	-	37.25	-	-
	104.0	-	1.20	-	455	-	29.09	-	-	-	-
125	105.0	-	-	1.52	450	456	-	-	35.02	-	-
	128.0	1.37	-	-	458	-	-	-	47.00	-	-
150	129.0	-	1.85	-	506	-	-	43.16	-	-	-
	130.0	-	-	2.34	500	508	-	-	-	57.87	-
175	153.0	1.96	-	-	606	-	-	61.97	-	-	-
	154.0	-	2.64	-	608	-	-	-	83.02	-	-
200	155.0	-	-	3.34	706	-	-	84.18	-	-	-
	178.0	2.66	-	-	700	708	-	-	-	112.69	-
200	179.0	-	3.58	-	808	-	-	-	158.00	-	-
	180.0	-	-	4.51	800	810	-	-	-	-	198.0
200	203	3.47	-	-	908	-	-	-	200.00	-	-
	204	-	4.66	-	900	910	-	-	-	-	250.0
205	-	-	5.86	-	-	-	-	-	-	-	-

Diametri *Diameters*  
Diamètres:

- ANSI/ASME  
 metrici *metric*  
 metriques

I pesi sono indicativi e relativi ai raccordi a "T" eguali.

Weights are approximate and for equal tees only.

Les poids sont indicatifs et relatifs aux tés égaux.

## Riduzioni troncoconiche



Esecuzione saldata

DN	dn	D	d	Th. (mm)		Kg/pz.
				1.5	2	
1"	3/8"	33.4	17.2	0.026	0.033	-
	1/2"		21.3	0.028	0.036	-
	3/4"		26.9	0.031	0.040	-
1 1/4"	1/2"	42.4	21.3	0.044	0.056	-
	3/4"		26.9	0.047	0.061	-
	1"		33.4	0.055	0.067	-
50	3/4"	53	26.9	0.071	-	-
	1"		33.4	0.078	-	-
	1 1/4"		42.4	0.086	-	-
50	3/4"	54	26.9	-	0.095	-
	1"		33.4	-	0.100	-
	1 1/4"		42.4	-	0.110	-
65	1"	68	33.4	0.120	-	-
	1 1/4"		42.4	0.130	-	-
	1 1/2"		48.3	0.130	-	-
65	50	69	53	0.140	-	-
	1"		33.4	-	0.160	-
	1 1/4"		42.4	-	0.170	-
65	1 1/2"	69	48.3	-	0.180	-
	50		54	-	0.190	-
	1 1/4"		42.4	0.180	-	-
80	50	83	53	0.200	-	-
	65		68	0.220	-	-
	1 1/4"		42.4	-	0.240	-
80	50	84	54	-	0.260	-
	65		69	-	0.290	-
	50		53	0.280	-	-
100	65	103	68	0.310	-	-
	80		83	0.340	-	-

DN	dn	D	d	Th. (mm)		Kg/pz.
				1.5	2	
100	50	104	54	-	0.38	-
	65		69	-	0.42	-
	80		84	-	0.46	-
125	65	128	68	0.45	-	-
	80		83	0.48	-	-
	100		103	0.53	-	-
125	65	129	69	-	0.60	-
	80		84	-	0.65	-
	100		104	-	0.71	-
150	80	153	83	0.65	-	-
	100		103	0.71	-	-
	125		128	0.78	-	-
150	80	154	84	-	0.88	-
	100		104	-	0.95	-
	125		129	-	1.05	-
175	100	178	103	0.91	-	-
	125		128	0.99	-	-
	150		153	1.08	-	-
175	100	179	104	-	1.22	-
	125		129	-	1.33	-
	150		154	-	1.44	-
200	100	203	103	1.14	-	-
	125		128	1.23	-	-
	150		153	1.33	-	-
200	175	204	178	1.42	-	-
	100		104	-	1.52	-
	125		129	-	1.65	-
200	150	204	154	-	1.77	-
	175		179	-	1.90	-





Dimensioni secondo ANSI/ASME e metriche

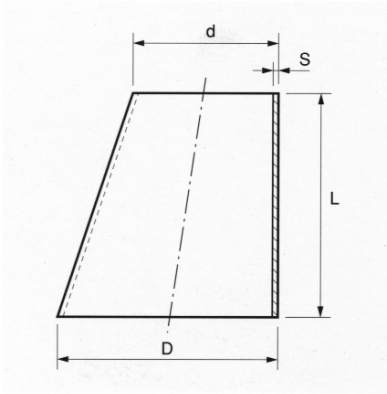
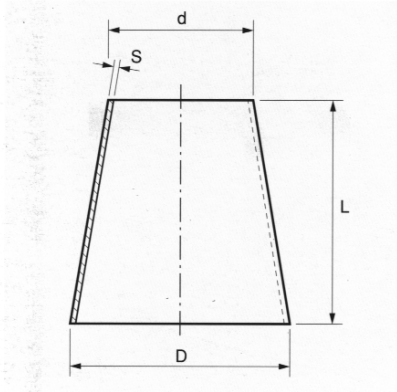

L = Øi

DN	dn	D	d	Th./(mm)			Kg/pz.
				2	2.5	3	
250	125	254	129	2.38	-	-	-
	150		154	2.53	-	-	-
	175		179	2.70	-	-	-
	200		204	2.85	-	-	-
250	125	255	130	-	2.98	-	-
	150		155	-	3.17	-	-
	175		180	-	3.37	-	-
	200		205	-	3.57	-	-
250	125	256	131	-	-	3.58	-
	150		156	-	-	3.82	-
	175		181	-	-	4.06	-
	200		206	-	-	4.29	-
300	150	305	155	-	4.28	-	-
	175		180	-	4.52	-	-
	200		205	-	4.75	-	-
	250		255	-	5.22	-	-
300	150	306	156	-	-	5.15	-
	175		181	-	-	5.43	-
	200		206	-	-	5.71	-
	250		256	-	-	6.28	-
350	200	355	205	-	6.09	-	-
	250		255	-	6.64	-	-
	300		305	-	7.19	-	-
	200		206	-	-	7.33	-
350	250	356	256	-	-	7.99	-
	300		306	-	-	8.65	-
	250		255	-	8.22	-	-
400	300	405	305	-	8.85	-	-
	350		355	-	9.48	-	-

L = Øi

DN	dn	D	d	Th./(mm)		Kg/pz.
				3	4	
400	250	406	256	-	9.88	-
	300		306	-	10.64	-
	350		356	-	11.39	-
450	300	455	305	10.66	-	-
	350		355	11.37	-	-
	400		405	12.08	-	-
	300		306	-	12.81	-
450	350	456	356	-	13.66	-
	400		406	-	14.51	-
	350		355	13.42	-	-
	500		400	505	405	14.20
500	450	506	455	14.99	-	-
	350		356	-	16.12	-
	400		406	-	17.06	-
	450		456	-	18.01	-
600	400	606	406	22.74	-	-
	450		456	23.87	-	-
	500		506	25.02	-	-
600	400	608	408	-	30.38	-
	450		458	-	31.89	-
	500		508	-	33.39	-
700	450	706	456	30.49	-	-
	500		506	31.80	-	-
	600		606	34.44	-	-
700	450	708	458	-	40.72	-
	500		508	-	42.48	-
	600		608	-	45.99	-

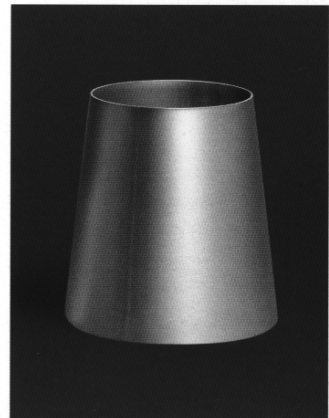

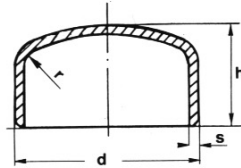
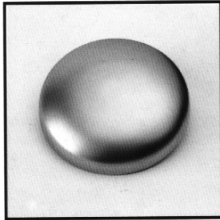

Fondo bombato  
 Cap  
 Rohrkappe

DN-ND	Ø GAS	d	Standard		S			
			h	DIN 2617 h	2	2,5	3	4
15	1/2"	21,3	11	15	•	•	•	
20	3/4"	26,9	11	15,5	•	•	•	
25	1"	33,7	13	20	•	•	•	
32	1" 1/4	42,4	13	21,5	•	•	•	
40	1" 1/2	48,3	13	22,5	•	•	•	
50	2"	60,3	20	30	•	•	•	
65	2" 1/2	76,1	22	33	•	•	•	•
80	3"	88,9	25	35	•	•	•	•
	3" 1/2	101,6	25	35	•	•	•	•
100	4"	114,3	30	40	•	•	•	•
125	5"	139,7	30	45	•	•	•	•
150	6"	168,3	45	51	•	•	•	•
200	8"	219,1	60	58	•	•	•	•
250	10"	273	65	71	•	•	•	•
300	12"	323,9	65	81	•	•	•	•
350	14"	355,9	90	85	•	•	•	•
350		350	105	85			•	•
400	16"	406,1	120	95			•	•
400		400	120				•	•
500	20"	508	135				•	•
500		500	135				•	•
600	24"	609,6	155				•	•
600		600	155				•	•